

## FERRITE TOROIDS

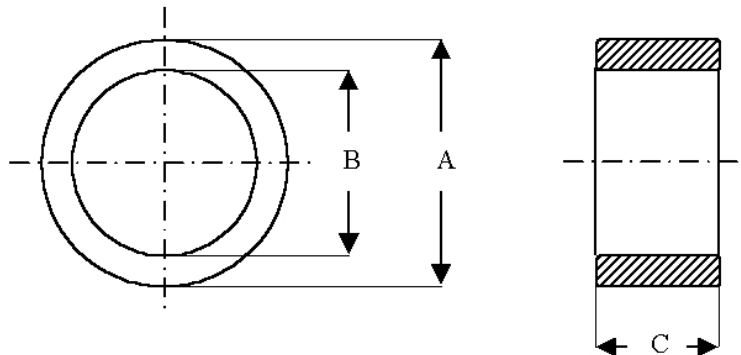

Core Type	Material	A	B	C	ALnH/t <sup>2</sup>
TR 4x2x2	2H5	4±0.3	2±0.25	2±0.20	930
TR 9x5x3	2H5	9.1±0.3	5.1±0.3	3.0±0.3	1400
TR 12x6x4	2G4	12+0.15 -0.3	6+0.3 -0	4±0.2	2900
TR 18x12x6	GQ5-C	18±0.3	12±0.2	6±0.2	2500
TR 18x10x7	CF129	18±0.4	10±0.4	7±0.3	5700
TR 20x10x7	CF197	20±0.3	10±0.2	7±0.3	6750
TR 25x15x12	GP-9	25±0.5	15±0.5	12±0.3	8100
TR 28x16x12	2E2	28±4.45	15.5±0.3	13±0.3	13100
TR34x22x15	GP-9	34±0.5	22±0.4	15±0.3	8800
TR36x23x17	CF197	36±0.7	23±0.5	17±0.4	10650

### Standard Characteristics of Mn-Zn Materials

Materials	$\mu_{iac}$ 10KHz	Tan $\sigma/\mu_{iac}$ 10KHz	$\alpha\mu_{iac}$ 20°C~60°C	Bms (mT)	Hc (A/m)	Tc (°C)	$\rho$ ( $\Omega\cdot m$ )	d (Kg/m <sup>3</sup> )
2E2	10000	1.5x10 <sup>-5</sup>	0.1x10 <sup>-6</sup> /°C	370	4.0	120	0.024	4.9x10 <sup>3</sup>
2G1	7000	0.54x10 <sup>-5</sup>	0.41x10 <sup>-6</sup> /°C	410	6.0	135	0.02	4.8x10 <sup>3</sup>
2E6	3000	0.1x10 <sup>-5</sup>	0.1x10 <sup>-6</sup> /°C	490	11.9	>200	0.23	4.9x10 <sup>3</sup>
GQ5-C	5300	0.5x10 <sup>-5</sup>	-	440	8.0	150	0.020	4.9x10 <sup>3</sup>
GP-9	7000	0.5x10 <sup>-5</sup>	-	430	8.0	130	0.010	4.9x10 <sup>3</sup>
GP-11	10000	1.0x10 <sup>-5</sup>	-	400	6.4	120	0.005	4.9x10 <sup>3</sup>
SB7-C	2400	2.0x10 <sup>-5</sup>	-	500	13	200	5	4.9x10 <sup>3</sup>

## Ferrite Toroids For Inductors Filter Coils and Transformers

Data sheet Ref: APS-6 (12/04/02)

**PACE**  
POWER MAGNETICS  
DIVISION



### Power Magnetics

10 Balmer Cut,  
Buckingham Industrial Park,  
Buckingham MK18 1UL

T 01280 817243

F 01280 823167

E sales@powermagnetics.co.uk  
[www.powermagnetics.co.uk](http://www.powermagnetics.co.uk)

A DIVISION OF  
**PACE**  
COMPONENTS  
LIMITED